



Attributes

Highlights	Description
<ul style="list-style-type: none">▪ Zero backlash with optimised fit between speed and transmission ratio▪ Connecting flange▪ Input shaft with tothing▪ Hollow shaft thru center of rotational axis▪ Preloaded ball bearing	<p>The MaalonDrive® Hollow 10mm - type 1 micro positioning gear is characterised by the combination of hollow shaft with tothing on the input shaft and a housing flange. Thanks to the hollow shaft, optical or electrical signals can be guided through the central rotary axis of the gear, thereby allowing a simple and space-saving design to be realised. The tothing on the input shaft enables positioning of the motor parallel to the hollow shaft and thereby improves use of the motor. The mechanical interface for attaching the micro positioning gear is a flange, by means of which the gearbox can be attached in the axial direction. Last, but not least, a zero-backlash MaalonDrive® gear component set with a reduction ratio of 160:1 is installed which, in combination with the preloaded ball bearing, enables a precise positioning behaviour.</p>

Technical parameter

The stated values are based on calculations and measurements by Micromotion GmbH, carried out according to the current state of the art. You can find our definitions at www.micromotion-drives.com.

For further information please contact sales@micromotion.de.

P-029

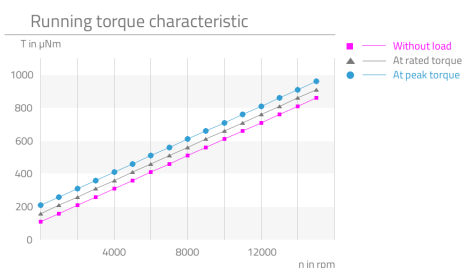

Nr.	Parameter	Symbol	Value	Hint
P-003	Ratio	i	160 : 1	
P-004	Self-locking		yes	
P-006	Hollow shaft		ja	
P-008	Repeatability unidirectional		15 arcsec	
P-009	Repeatability bidirectional		20 arcmin	
P-010	Accuracy		12 arcmin	
P-011	Transmission accuracy		24 arcmin	
P-013	Torsional stiffness		8.25 $\frac{\text{Nm}}{\text{rad}}$	
P-014	Lost motion		12 arcmin	
P-015	Backlash		0 arcmin	
P-016	Rated torque	T	5 mNm	
P-017	Peak torque	T	10 mNm	
P-018	Momentary peak torque	T	23 mNm	
P-021	Rated input speed	n	10000 rpm	
P-022	Maximum input speed	n	30000 rpm	
P-023	Rated output speed	n	62.5 rpm	
P-024	Maximum output speed	n	187.5 rpm	
P-026	No-load starting torque	T	165 µNm	
P-027	No-load running torque	T	110 µNm	

Technical Supply Specifications: MaalonDrive® Hollow 10mm - Type 1



Micromotion GmbH, Phone: +49 (0) 6431 – 569 18 – 25, E-mail: sales@micromotion.de

Nr.	Parameter	Symbol	Value	Hint
P-028	Rated running torque	T	690 µNm	
P-034	Lifetime for rated operation		1000 h	
P-035	Radial backlash output shaft		0 µm	
P-036	Axial backlash output shaft		0 µm	
P-037	Radial stiffness	c	11.32 N/µm	
P-038	Axial stiffness	c	40 N/µm	
P-039	Max. radial load on output shaft (non-operating, constant load)	F	135 N	
P-040	Max. radial load on output shaft (non-operating, impulsive load)	F	45 N	
P-041	Max. radial load on output shaft (operating, constant load)	F	32 N	
P-042	Max. radial load on output shaft (operating, impulsive load)	F	32 N	
P-043	Max. axial load on output shaft (non-operating, constant load)	F	150 N	
P-044	Max. axial load on output shaft (non-operating, impulsive load)	F	50 N	
P-045	Max. axial load on output shaft (operating, constant load)	F	380 N	
P-046	Max. axial load on output shaft (operating, impulsive load)	F	127 N	
P-047	Max. radial load on input shaft (non-operating, constant load)	F	20 N	
P-048	Max. radial load on input shaft (non-operating, impulsive load)	F	6 N	
P-049	Max. radial load on input shaft (operating, constant load)	F	15 N	
P-050	Max. radial load on input shaft (operating, impulsive load)	F	6 N	
P-051	Max. axial load on input shaft (non-operating, constant load)	F	30 N	
P-052	Max. axial load on input shaft (non-operating, impulsive load)	F	10 N	
P-053	Max. axial load on input shaft (operating, constant load)	F	100 N	
P-054	Max. axial load on input shaft (operating, impulsive load)	F	38 N	
P-055	Moment of inertia	I	60 * 10 ⁻⁴ gcm ²	
P-056	Weight	m	9 g	
P-057	Min. permissible ambient temperature (non-operating)	T	-80 °C	
P-058	Min. permissible ambient temperature (operating)	T	-20 °C	

Technical Supply Specifications: MaalonDrive® Hollow 10mm - Type 1



Micromotion GmbH, Phone: +49 (0) 6431 – 569 18 – 25, E-mail: sales@micromotion.de

Nr.	Parameter	Symbol	Value	Hint
P-059	Max. permissible ambient temperature (non-operating)	T	150 °C	
P-060	Max. permissible ambient temperature (operating)	T	120 °C	
P-063	Kind of gear wheel input shaft		Spur gear DIN 867	
P-064	Module gear wheel input shaft		0.2 mm	
P-065	Number of teeth gear wheel input shaft		42	
P-066	Pitch diameter gear wheel input shaft		8.4 mm	
P-067	Pressure angle gear wheel input shaft		20 °	
P-069	Material gear wheel input shaft		1.4305	

Material information

Nr.	Parameter	Symbol	Value	Hint
P-900	RoHS compliant		yes	
P-901	Lubrication of output bearing gearbox		Longtime PD2/ Molykote BR 2 plus	
P-902	Lubrication of input bearing gearbox		Longtime PD2/ Fomblin GRM60	
P-908	Material of gear component set		NiFe	
P-909	Material of output bearing gearbox		1.4108 DIN EN	
P-910	Material of input bearing gearbox		1.4108 DIN EN	
P-912	Material of gearbox output side		1.4305 DIN EN	
P-913	Material of gearbox input side		1.4305 DIN EN	

Technical Supply Specifications: MaalonDrive® Hollow 10mm - Type 1



Micromotion GmbH, Phone: +49 (0) 6431 – 569 18 – 25, E-mail: sales@micromotion.de

Technical drawing

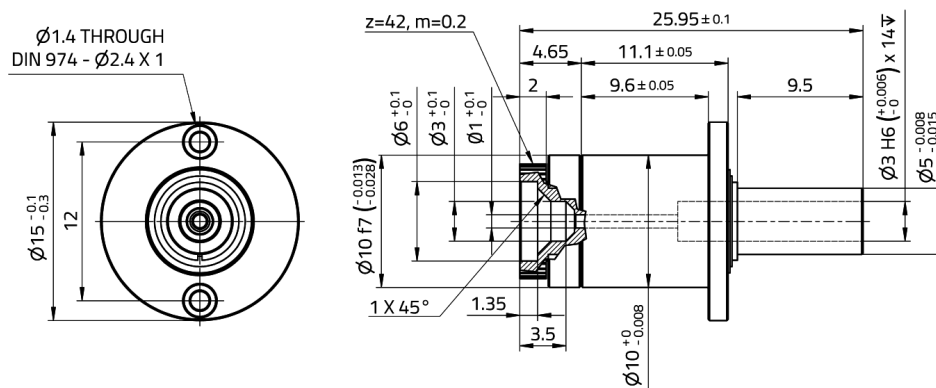

Micromotion GmbH | Hoenbergstraße 14 | 65555 Limburg
+49(0)6431-59618-25 | sales@micromotion.de | www.micromotion-drives.com